

ZSSP Shear off screw connector

up to 1 kV

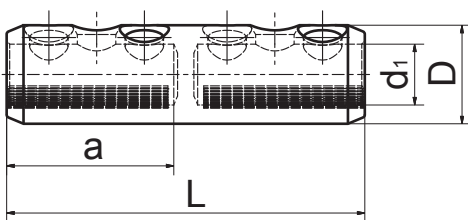

Symbol	Al conductor cross section [mm ²]						Cu [mm ²]				d ₁ [mm]	D [mm]	L [mm]	a [mm]
	rmv	rm	re	sm	se	class 5	rmv	Rm	sm	class 5				
ZSSP 1695	16-95	16-95	16-95	25-70	16-95	16-70	16-95	16-95	25-70	16-70	13	24	70	32
ZSSP 50150	35-150	50-120	50-150	50-120	50-150	50-120	35-150	50-120	50-120	50-120	15,5	30	85	39
ZSSP 95240	95-240	95-185	95-240	95-185	95-240	95-185	95-240	95-185	95-185	95-185	20,4	33	120	56
ZSSP 120300	120-300	120-300	120-300	120-240	120-240	120-300	120-300	120-300	120-240	120-240	25	38	142	67
ZSSP 400630	400-630	400-630	400-630	400-500	-	400-500	400-630	400-630	400-500	400-500	34	52	200	94
ZSSP 6301000	630-1000	630-1000	630-1000	-	-	630-800	630-1000	-	-	630-800	41	60	220	105