

**acar**[®]

acar SMART basic

Compact surge protective power strip

**6** SOCKETS WITH EARTHING PIN

SOCKET OUTLETS SAFE FOR CHILDREN

ILLUMINATED DOUBLE POLE MAINS SWITCH

SURGE PROTECTION

2 AVAILABLE COLOUR VARIANTS

AVAILABLE POWER CORD LENGTHS: 1.5m, 3m

The **acar SMART basic** power strip is a modern protection of electronic equipment against effects of spikes and surges in the power lines. Due to the small size it is easy to place it on a desk or put it in a cabinet along with home theatre set. The **acar SMART basic** protects up to six components of a computer set (notebook, monitor, printer, power supply, charger) or Audio & Video set (home cinema, LCD / OLED TV, Blu-ray players, satellite TV and DVB-T receivers). Easily accessible switch allows quick disconnection of connected appliances thus reducing energy consumption, reducing its operating costs and contributing to environmental protection.

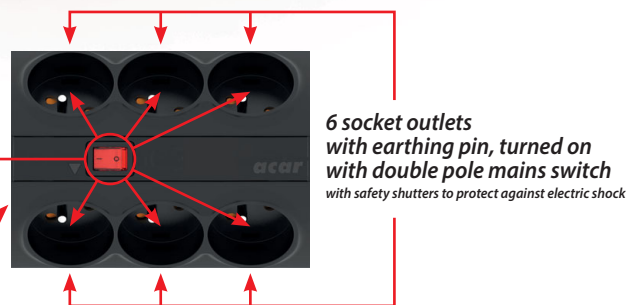

ILLUMINATED DOUBLE POLE MAINS SWITCH TURNING ON SOCKET OUTLETS



6 SOCKET OUTLETS 10A WITH EARTHING PIN



MOUNTING HOLES AND 3 POSSIBLE WAYS OF POWER CABLE ROUTING

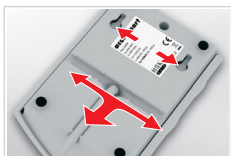

MOUNTING OF ANTI-SLIP FEET

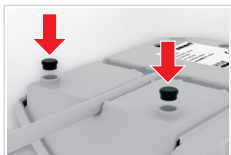
**Technical data: acar SMART basic**

Maximum load	P_{MAX} 2300W
Nominal voltage U_N	230V
Nominal frequency	50Hz
Nominal load current	$\Sigma I_N = 10A$ MAX
Surge protection response time	<25ns
Maximum voltage U_C	250V 50Hz
Protection level U_p	$\leq 1.3kV$
Nominal discharge current i_N	2kA (L/N) – 8/20 μs
Maximum discharge current i_{MAX}	6.5kA (L/N) – 8/20 μs
Anti-shock protection system	earthing pins connected to the protective earthing conductor
Number of socket outlets	6 two-pole socket outlets with earthing pin, 10A/250V
Switch	illuminated double pole mains switch
Housing	made of self-extinguishing plastic
Dimensions	138x100x63mm
Weight	0.41kg

The manufacturer reserves the right to change the technical parameters of the device, resulting from technological progress.
ATTENTION! The technical data define the maximum values of surges against which the device protects.